

WH-2011F1
 WH-2013F1
 WH-2513F1
 (C)

零件表PARTS LIST WH-2011F1 / WH-2013F1 / WH-2513F1 (C)

圖號 NO.	編號 CODE	名稱	DESCRIPTION	Q'TY	圖號 NO.	編號 CODE	名稱	DESCRIPTION	Q'TY
01	B010123000	曲軸箱	CRANKCASE	1	09-2	B011023100	全密曲軸油封蓋	END COVER OIL SEAL COVER	1
02	B010210010	柱塞油封	PISTON OIL SEAL	3	10	B011623000	曲軸箱後蓋	REAR COVER	1
03-3	B013223010	柱塞套	CERAMIC PISTON SLEEVE	3	10-1	BG11012106500	O形環	O-RING	1
03-4	B013511110	柱塞套透氣墊圈	GASKET	3	10-2	BS16206016501	內六角螺絲	SCREW	5
03-5	B013510020	柱塞套平墊圈	GASKET	3	10-3	BS32206200	彈簧華司	SPRING WASHER	5
03-6	B013123001	柱塞桿	PISTON ROD	3	11	B012201020	油鏡	OIL WINDOW	1
03B	B015223001	柱塞螺絲組	PISTON SCREW ASSY	3	11-1	BG10234028700	O形環	O-RING	1
03-7	B013410020	柱塞套固定螺帽	PISTON SET NUT	3	12	B011823000	排油螺絲	DRAINAGE SCREW	1
03-8	B013510002	柱塞套平墊圈	GASKET	3	12-1	BG10130019	O形環	O-RING	1
03-9	BG10050009060	O形環	O-RING	6	13	B011901014	加油蓋組	OIL INLET COVER ASSY	1
03-10	BG30053008200	背托環	BACK-UP RING	3	14	B020123000	汽缸	MANIFOLD	1
03-11	B013323010	柱塞套固定螺絲	PISTON SET SCREW	3	14-1	BS16208070500	內六角螺絲	SCREW	8
04	B010523000	柱塞銷	PISTON PIN	3	14-2	BS33208400	安全華司	SAFETY WASHER	8
05A	B010623001	連桿組	CONNECTING ROD ASSY	3	15	B020323001010	U迫緊	U-PACKING	3
05	N/A	連桿	CONNECTING ROD	3	16	B020323021	墊圈	SPACER	3
05-1	BS11206030500	六角螺絲	HEX SCREW	6	18	B021123001	迫緊上環	PACKING UPPER RING	3
05-2	BS31206501	平面華司	WASHER	6	18-1	BG10300035030	O形環	O-RING	3
05-3	B014311000	螺絲防鬆片	LOCK WASHER	3	18-2	B021210020	迫緊中間環	U-PACKING SPACER RING	3
06	B010710010	軸承	BEARING	2	19	B021010020	防水油封	WATREPROOF OIL SEAL	3
07	B010823000	曲軸 (WH-2011F1)	CRANKSHAFT (WH-2011F1)	1	20	B021310050	活門固定螺絲 (無孔)	VALVE BOLT W/O HOLE	5
	B010823001	曲軸 (WH-2013F1/2513F1)	CRANKSHAFT (WH-2013F1/2513F1)		20-1	BG10200025020	O形環	O-RING	6
07-1	B012109000	曲軸鍵	CRANKSHAFT KEY	1	20-2	BJ21001210	活門輔助彈簧	VALVE AUXILIARY SPRING	5
08	B010910040	曲軸油封	CRANKSHAFT OIL SEAL	1	21	B021410050	活門固定螺絲 (有孔)	VALVE BOLT W/HOLE	1
08-1	B010923100	全密曲軸油封	END COVER OIL SEAL	1	22A	B040011031	活門組	VALVE ASSY	6
09	B011023000	曲軸油封蓋	CRANKSHAFT OIL SEAL COVER	1	22-1	B040310010	活門帽 (POM)	VALVE CAGE (POM)	6
09-1	BS16206016501	內六角螺絲	SCREW	8	22-2	BJ20901000	活門彈簧	VALVE SPRING	6

零件表PARTS LIST WH-2011F1 / WH-2013F1 / WH-2513F1 (C)

圖號 NO.	編號 CODE	名稱	DESCRIPTION	Q'TY	
22-3	B040109001	活門塞	VALVE PLUG	6	
22-4	B040211000	活門座	VALVE SEAT	6	
23	BG10160021020	O形環	O-RING	6	
24	BS50004000	六角塞頭 PT1/8	PLUG PT1/8	1	
25	B021701000	進水接頭	INLET CONNECTOR	1	
26	1S50012040	內六角油塞 PT3/8	PLUG PT3/8	1	
27	1S50016040	內六角油塞 PT1/2	PLUG PT1/2	1	
28	B031210000	壓力錶接頭	PRESSURE GAUGE CONNECTOR	1	
29	B031110000	壓力錶	PRESSURE GAUGE	1	
*30A	B070023200	自動洩壓總成	UNLOADING VALVE ASSY	1	
30-1	B071810000	外部迴水接頭	OVERFLOW CONNECTOR	1	
31	BS11206060300	六角螺絲	HEX SCREW	1	
31-1	BS21206300	六角螺帽	HEX NUT	2	
32	B010307000	腳座	CRANKCASE STAND	2	
32-1	BS11210015222	六角螺絲附華司	HEX SCREW W/ WASHER	4	
ACC.	B150110003	吸水管組 3/4"*10尺	INLET HOSE ASSY 3/4"*10FT	1	
ACC.	B150201001	迴水管組 1/2"*9尺	OVERFLOW HOSE ASSY 1/2"*9FT	1	
ACC.	B150609120	過濾網申目	FILTER SOCKET	1	
ACC.	B150909110	過濾網	FILTER	1	
ACC.	BP20612240	皮帶輪 4A2*24*8(外銷用)	PULLEY 4A2*24*8 (FOR EXPORT)	1	
ACC.	BS11112025121	皮帶輪螺絲(外銷用)	PULLEY SET BOLT (FOR EXPORT)	1	
*30A零件表及展開圖請參閱第4頁。			*30A parts list & diagram please refer to page 4.		
			2024.01V		

高壓洗淨機(馬達系列)特點說明:

- 結構堅固：三支陶瓷柱塞式泵浦，鍛造銅汽缸，結構堅固。
- 強力馬達：採用工業級馬達，具備安全保護裝置。
- 超耐磨柱塞：高硬度陶瓷柱塞及特殊迫緊設計，可長時間使用及延長使用壽命。
- 自動停機：利用噴槍開關自動控制馬達的啟動與停止，節省能源。
- 洩壓調壓閥：泵浦採用自動洩壓調壓閥設計，壓力穩定。
- 陶瓷噴頭：採用陶瓷噴嘴，耐磨耗，可延長使用壽命。

High Pressure Cleaner (Motor Series) Features:

- Lightweight high-pressure cleaners are equipped with large wheels and supporting castors to ensure the unit is easy to maneuver and park.
- Newly developed class F motor made of aluminum alloy is equipped with overload protection device.
- Robust tri-plunger pump with industrial grade ceramic plungers and V-packings provides long-time use and long product life.
- Motors start and stop automatically by squeezing and releasing the spray gun trigger to save energy.
- Equipped with unloader to stabilize the pressure.
- Specially designed cylinder directs water into the packings for cool and lubrication.



圖號 NO.	編號 CODE	名稱	DESCRIPTION	Q'TY
61	B070111050	洩壓汽缸套	UNLOADING VALVE CYLINDER	1
62	BJ50901000	洩壓輔助彈簧	AUXILIARY SPRING	1
63A	B070609001	柱塞活門組	PISTON VALVE ASSY	1
63	B070609000	柱塞活門體	PISTON VALVE BODY	1
63-1	BG10150020020	O形環	O-RING	2
63-2	BG30162020	背托環	BACK-UP RING	3
64	B070709000	止水閥塞	STOP VALVE PLUG	1
65	BJ30901000	球閥固定彈簧	SPRING	1
66	B070809000	球閥固定套	BALL VALVE SEAT	1
67	B071109051	固定環	SET RING	1
67-1	BS17106005300	無頭內六角螺絲	SCREW	2
68	B070509000	壓力閥桿	PRESSURE VALVE ROD	1
69	B070909000	消音片	DAMPER PLATE	1
70	B070309000	陶瓷球閥	CERAMIC BALL VALVE	1
71A	B070409001	壓力閥座組	PRESSURE VALVE SEAT ASSY	1
71	B070409000	壓力閥座	PRESSURE VALVE SEAT	1
71-1	BG30183022310	背托環	BACK-UP RING	1
71-2	BG10170022020	O形環	O-RING	1
71-3	BG10200025020	O形環	O-RING	1
72C	B070211050	迴水座	OVERFLOW CHAMBER	1
72-1	BG10108015640	O形環	O-RING	2
72-2	BS16108025500	內六角螺絲	SCREW	4
72-3	BS33206400	安全華司	SAFETY WASHER	4
73	B071409001	彈簧下座	SPRING SEAT	1
73-1	B071311000	彈簧上座	SPRING SEAT (UPPER)	1
74	BJ41101000	調壓彈簧	PRESSURE REGULATING SPRING	1

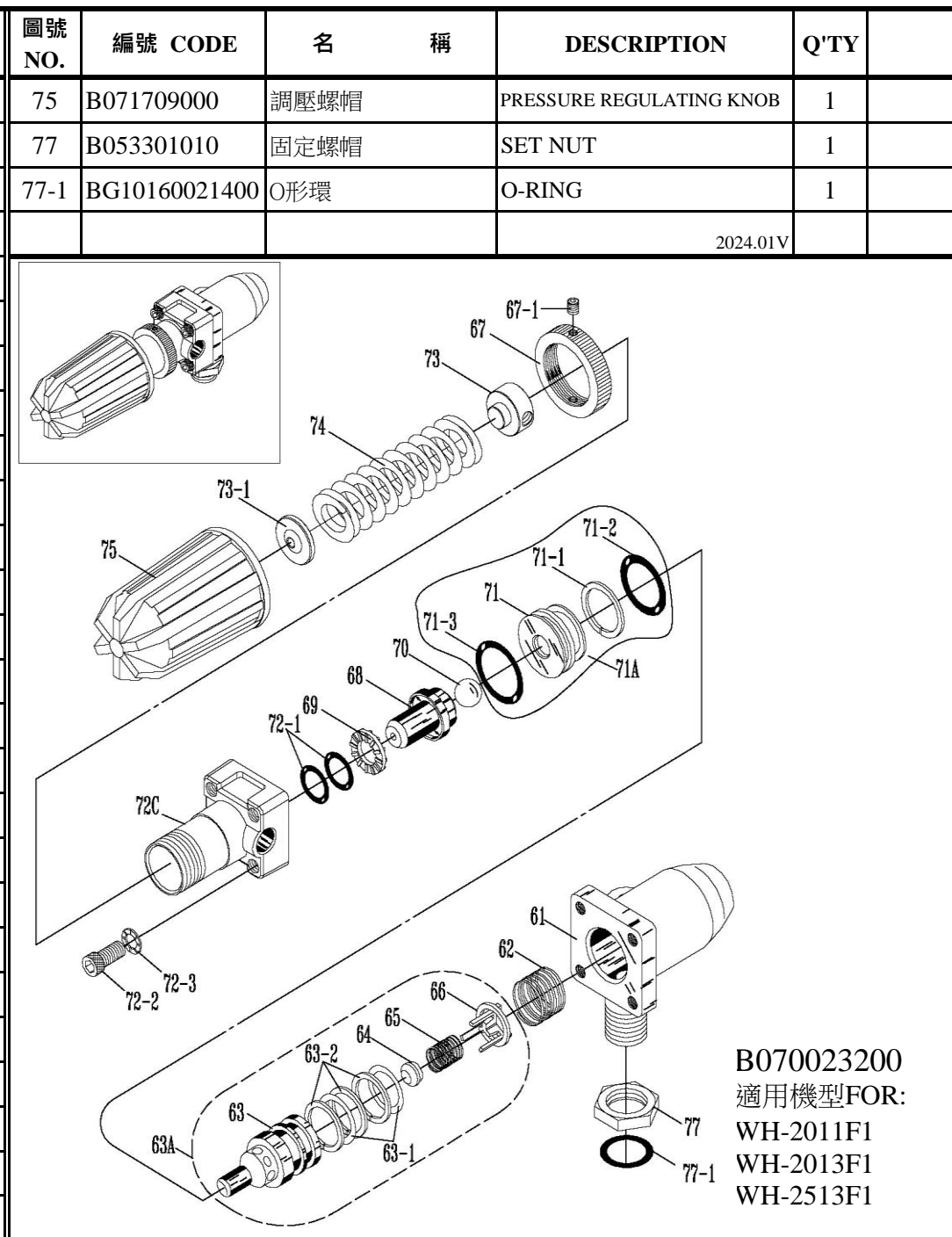

2024.01V